

END SECTION
SCALE 1:25

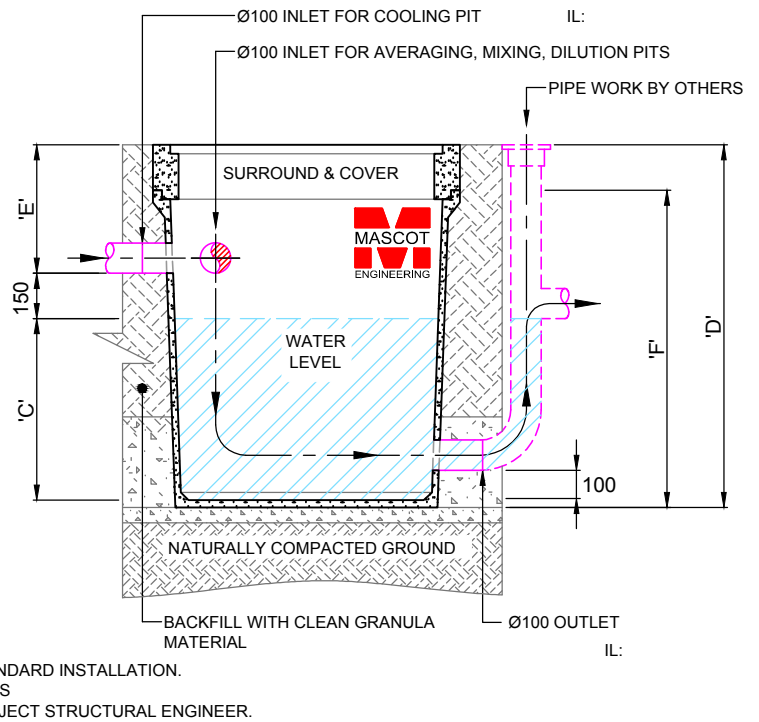

SIDE SECTION
SCALE 1:25

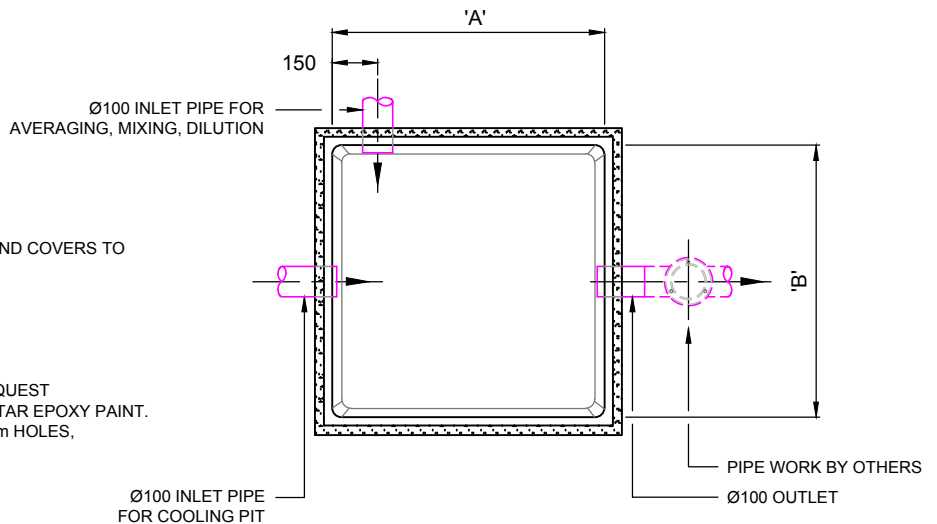

OPEN TANK PLAN VIEW
SCALE 1:25

PRODUCT NOTE:

1. 300mm RISERS AVAILABLE.
2. LARGE RANGE OF CONCRETE SURROUNDS AND COVERS TO SUIT ALL LOAD RATINGS.
3. MPa RATING FOR GRC - 60 MPa @ 28 DAYS.
4. AVAILABLE EXTRAS:
 - STEP IRONS
 - SUPPORT FRAME & WORK PLATFORMS FOR ABOVE GROUND INSTALLATIONS.
5. OTHER PVC PIPE SIZES AVAILABLE UPON REQUEST
6. INTERNALLY COATED WITH ACID RESISTANT TAR EPOXY PAINT.
7. STAINLESS STEEL BASKET FITTED WITH Ø3mm HOLES, AVAILABLE FOR LINT TRAP.

PRODUCT CODE	CAPACITY (L)	A	B	C	D	E	F	MASS (KG)
AMDCL 2	200	600	600	600	1200	450	1100	115
AMDCL 4	400	900	900	600	1200	450	1050	205
AMDCL 6	600	900	900	750	1200	300	1050	230
AMDCL 8	800	1200	1200	720	1400	530	1200	375
AMDCL 10	1000	1200	1200	900	1700	650	1500	475
AMDCL 12	1200	1200	1200	1075	1700	475	1500	510
AMDCL 15	1500	1200	1200	1350	2000	500	1800	570

SPECIFICATION

Glass Reinforced Concrete Averaging, Mixing, Dilution, Cooling Pit free of steel reinforcement to prevent corrosion.
 Averaging, Mixing, Dilution, Cooling Pit to be Mascot Engineering GRC litre, model number AMDCL complete with Gastight Access Covers to suit Class load rating to AS3996.
 Products to be installed as per the manufacturers installation instructions

© Copyright

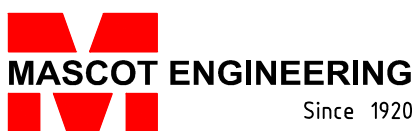

PRODUCT DESCRIPTION:
**AVERAGING, MIXING,
 DILUTION, COOLING PIT**

ph: 1300 885 295
 fax: 1300 885 296
 email: sales@mascoteng.com.au
 www.mascotengineering.com.au

SCALE:
1:25

REVISION:
A

DRAWING NO:
TW.AMDCL.001